

# Spin Dryer Mini VC-15S/SP

Compact-size Centrifugal Concentrator is easy to use with Benchtops. Optimal for concentration in Microtubes or Vials. For drying after Ethanol precipitation, VC-15SP with a built-in pump. With 15S, combined with a general-purpose pump, the throughput is higher.

•Cold Trap and vacuum pump are optimum for this product --> P.161



Model	VC-15S	VC-15SP
Temperature range	Approx. +55°C when the Heater is turned on	
Rotational speed	Approx. 2000 r/min (fixed)	
Vacuum release	Timer automatic release (also Manual)	Manual
Rotor rotation system	Magnet drive	
Timer	60 min (Analog)	
Lid/Chamber material	Lid: Glass, Chamber: Stainless steel SUS304 (Teflon coated)	
Vacuum gauge	0 to -100 kPa (Bourdon tube)	
Vacuum Pump	Required separately (*1)	Built-in, Approx. -80 kPa. to -4 L/min (Another pump can be used) (*1)
Suction nozzle outer dia.	φ8 and φ14 mm (Exchangeable)	Pisco φ8 mm
Sterilization filter	0.2 μm	
Other function	Pump switch interlocking outlet × 1 (to 7 A) (VC-15S)	
Safe devices/ protections	Overheat protection, Thermal fuse, Heater and Rotation stop when lid is open	
Dimensions (W×D×H)	171 × 236 × 175 mm	
Weight	Approx. 3 kg	Approx. 4.8 kg
Power supply	AC100V/1A /Max.10A(*2) (Need a step-down transformer)	AC100V/1A (Need a step-down transformer)
Standard accessories	φ8 and φ14 mm Nozzle × 1 pc	15A Rotor × 1 pc Vacuum pump protection filter × 1 pc

(\*1) When using an external pump, the Diaphragm vacuum pump (displacement up to 50 L/min) is recommended.  
(\*2) In VC-15S, the current will increase according to the use of the Pump interlocking outlet.

## Dimensions (Common in all models)

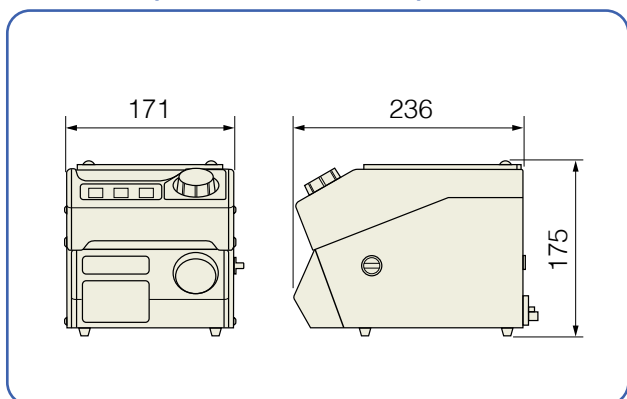

We contribute to the development of research and industry.  
**TATEC** [ General Catalog ]

## Features

- Compact but full-scale chemical-resistant chamber
- Rotor that can be used while the tube lid is open
- Simple and easy-to-use controls

## Applications

- Drying process after Ethanol precipitation, small volume concentration [15S]
- For concentration of water-soluble and solvent samples [15SP]
- A wide variety of rotors sold separately for small volume vessels

## Easy Operation

Centrifugal concentration is started simply by turning on the timer and switching on the rotor, heater, and pump in that order. In the VC-15SP, the built-in pump is operated by the pump switch; in the VC-15S (as well as the larger series VC-36R/96R), the pump switch and vacuum pump operation are interlocked by using the outlet on the rear panel.



## Optional accessories: Angle Rotors



Model	Vessels and Capacity	Approximate processing capacity (*)
15A	Microtubes: 1.5/2.0 mL × 12 pcs + 0.2 mL × 32 pcs (included in VC-15SP)	12 mL
15B	Microtubes: 1.5/2.0 mL × 12 pcs + 0.5 mL × 24 pcs	12 mL
15C	Microtubes: 1.5/2.0 mL × 20 pcs	20 mL
15D	Micro vials: 1.5/2.0 mL × 12 pcs	12 mL
15E	Microtubes: 5 mL × 6 pcs (Screw cap type is not suitable.)	15 mL

(\*) This is when a pump is connected to VC-15S. The maximum processing capacity of a 2.0 mL vessel and a 5.0 mL tube is 1/2 the volume of the vessel. The total processing capacity of the VC-15SP should be limited to a total of 2 mL.

# System upgrade for the VC-15 Series

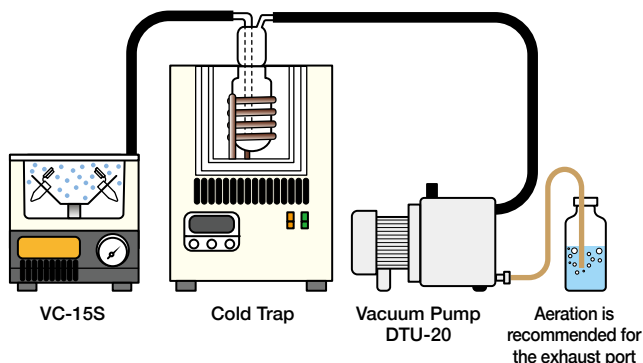

## Optional accessories: Diaphragm-type Vacuum Pump



Model	DTU-20
Chemical resistance (*)	Water, Mild acidity, Organic solvent
Displacement	20 L/min
Ultimate pressure	to 0.2 kPa (adjustable by valve)
Standard accessories	Vacuum hose (2 m), Nozzle port

(\*)As it is not completely resistant, keep in mind that when use it.

## About the Cold Trap



When centrifugally concentrating ethanol precipitation samples with the VC-15SP, which has a built-in pump, the heater should basically be turned on.

If the total liquid volume of the sample exceeds 2 mL or if the sample can be disturbed by turning on the heater, select the VC-15S. In such cases, we recommend combining with the Teflon diaphragm pump DTU-20 (see above right), connecting a hose to the vacuum pump's exhaust port for exhausting, and "aeration" with water in a chemical bottle, etc. When concentrating a high salt concentration sample, it is recommended to run the unit dry for 15 minutes after the completion of the concentration in order to reduce the valve deterioration of the vacuum pump.

Use a cold trap to collect vaporized or sublimated solvents. Select a lid with nozzles (NF-025/040) or a glass condenser (GC-035/070) according to the solvent to be collected, and then use in combination with the cold trap.

## About the disposable chemical filter

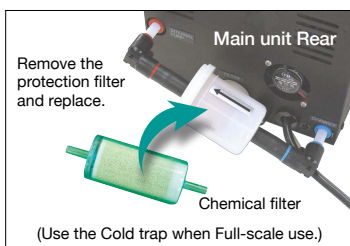

The VC-15SP can be equipped with an optional disposable chemical filter. As shown in the left figure, the filter is installed in place of the vacuum pump protection filter (standard accessory). Refer to the table below for application guidelines. After concentration, remove the filter and dry it before the next use.

For the VC-15S, please perform aeration on the exhaust side of the pump without using a chemical filter. Please dispose of the water used for aeration as industrial waste in a timely manner.

## Option: Disposable Chemical Filters (for the VC-15SP) (Replace every 1 to 2 months when used frequently.)

Model	Adsorbent	Main Adsorbable substances
CT-000-3	Activated carbon	Compressor oil vapor, C5 and other Hydrocarbons, Ketones, Alcohols, Esters, Organic acids, Aromatic, Oxides of Hydrocarbons, Chlorinated organic substances, Freon™, and Carbon disulfide
CT-103-3	Molecular sieve 13X	Carbon dioxide, Ammonia, Sulfur dioxide gas, Hydrogen sulfide, Acetylene, Propylene, Methane, Ethane, Ethylene oxide, Carbon disulfide linear Mercaptans, Linear Hydrocarbons (to C22), Cyclohexane, Butane-1, Isopentane, Benzene, Toluene, Xylene diphenyls, Triethylamine, and other Amines.

\*Dispose the Organic solvents contained in the exhaust from the pump in the draft or by aeration.

## Reference Line graph

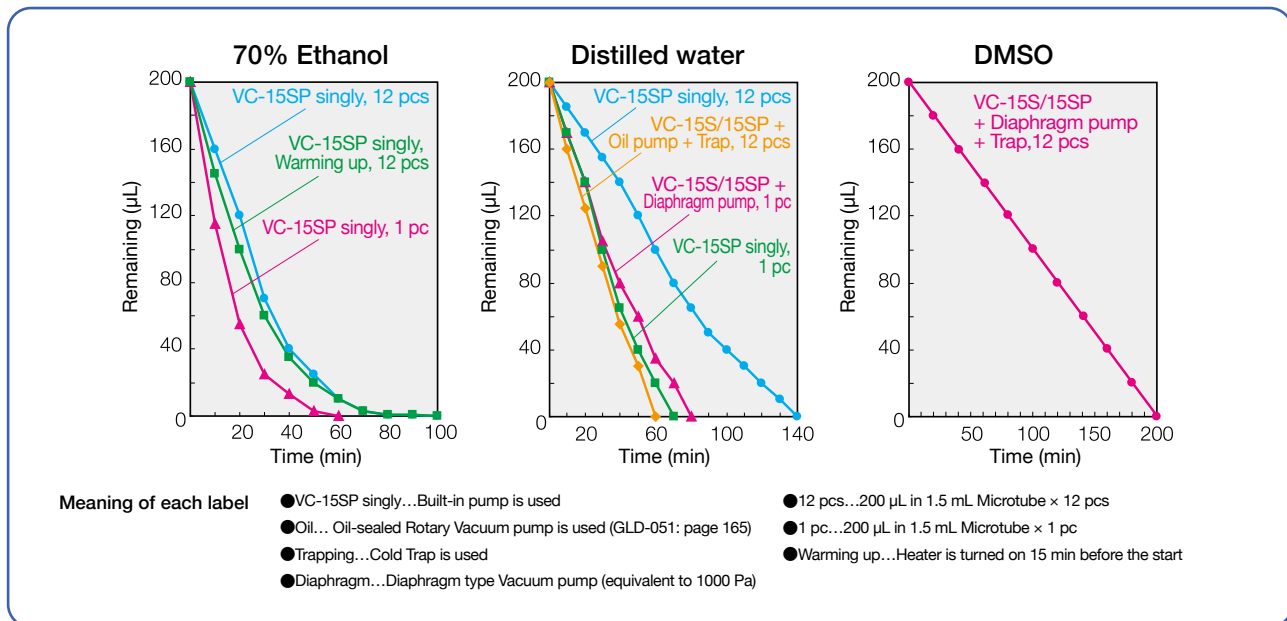

NEW  
Constant temperature incubator/shaker  
OD Monitor  
For cell culture related products  
Shaker  
Mixer Rotator Stirrer  
Bead beater homogenizer  
Ultrasonic homogenizer  
Aluminum block Bath  
Mini-size Bath  
Water bath  
Shaking Water bath  
Immersion cooler  
Hybridization Incubator  
Constant temperature Chambers  
Centrifugal Concentrators  
Cold Trap  
Freeze dryers  
Substrate Electroporation apparatus  
Blotting device for hybridization  
Constant-temperature water circulating system [Chilled]  
Appendix